

User Guide

SINCLAIR
RESEARCH

WDU
WHEELCHAIR DRIVE UNIT

For attendant use only

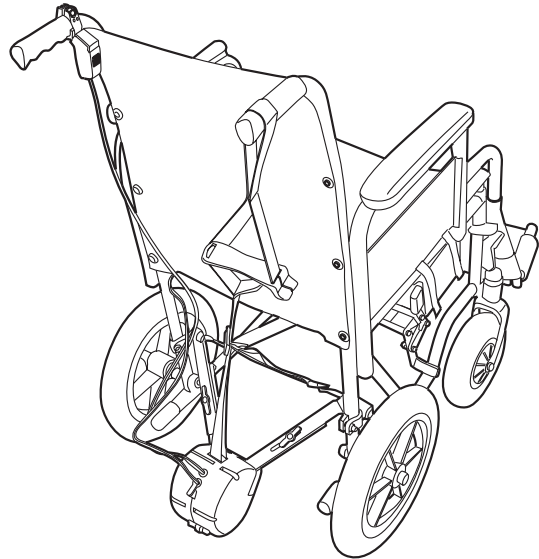

Model no. ZA20

Please retain this manual for future reference

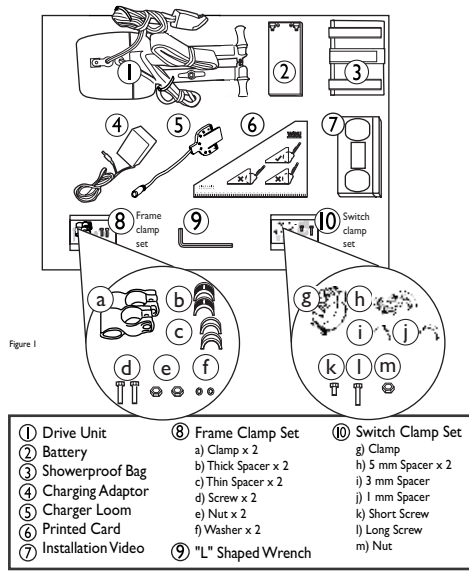

Figure 1

1.1.1 Attach Switch
Snap the switch clamp onto the handlebar opposite the lifting strap (Figure 23). The clamp will stretch to fit over most rubber hand grips or can snap directly onto the metal frame.

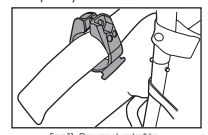

Figure 23 - Clamp snapped over handlebar.
If you snap the clamp onto the metal frame directly, it may be a loose fit. If so, choose one or two spacers from those provided and insert them inside the clamp to give a snug fit (Figure 24).

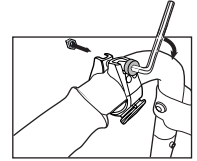
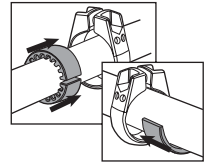

Figure 25 - Tighten screw with L-shaped wrench

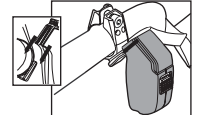
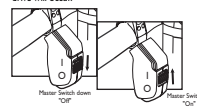

Figure 26 - Slide switch unit into position

The master switch has an "On" position (marked I) and an "Off" position (marked O) as shown in Figure 27. When in the Off position the trigger can still be pressed but no drive will occur.



Please Switch Down "Off" Please Switch Up "On"

